

8
9
10
11
12
13
14
15
16
17
18
19
20
21
22
23
24
25
26
27
28
29
30
31
32
33
34
35
36

May 10-1905

- A. Stone 6x6x36
- B. ... at Gov. cor.
- C.
- D.
- E. Fence cor. about 25 ft. So. 37.5 West
- F. Established by previous survey
Fence cor 33 ft. W. + 34.5 South
- G. Established by previous survey
- H. Stone in Gov. cor.
- I.
- X Stone on 80 lines

J. W. Woolstencroft

Oct. 24 1922

B. Found old stake put in stone 14" long and deposited small stones around

9" 5/4 Bar - Located Large Field stone 6' 0" Below Oil Mat; placed 18" steel pin above stone at surface of grade; R.P. N4C. Brass Post NW 49.45; R.P. N4C Cor Post N. 50.10; R.P. First Steel Fence Post NE. 53.36. Sept 30, 1974

"H" SW. Sec Cor. Located Gov Mound of field stones 4.8' below surface of bituminous mat; placed 18" 6-bar above mound at surface of

oil mat: 6" P. N4C 1" P. S.E. 68.40; R.P. N4C. ^{File 100} Brass Pin SW. 68.09

Oct 8, 1974 - 2 1/2" Bitum. surface, 5 1/2" gravel Base, 1 1/2" Back Clay to old road.

"C" found large field stone 2' below grade. Placed 1/2" x 1 1/2" iron pin over stone. R.P. N4C P.P. N.W. 46.80' south edge of steel cor. Post North 31.78, North edge of south steel post 31.16.

"B" found pit mound of stone 6' below grade. Placed 1/2" x 1 1/2" iron pin above mound but 4" below grade. R.P. N4C in P.P. S.W. 36.46 N4C P.P. N.W. 43.04 N4C Cor Post S.E. 20.91

SURVEY No. _____

Section 9

Town 108

Range 42

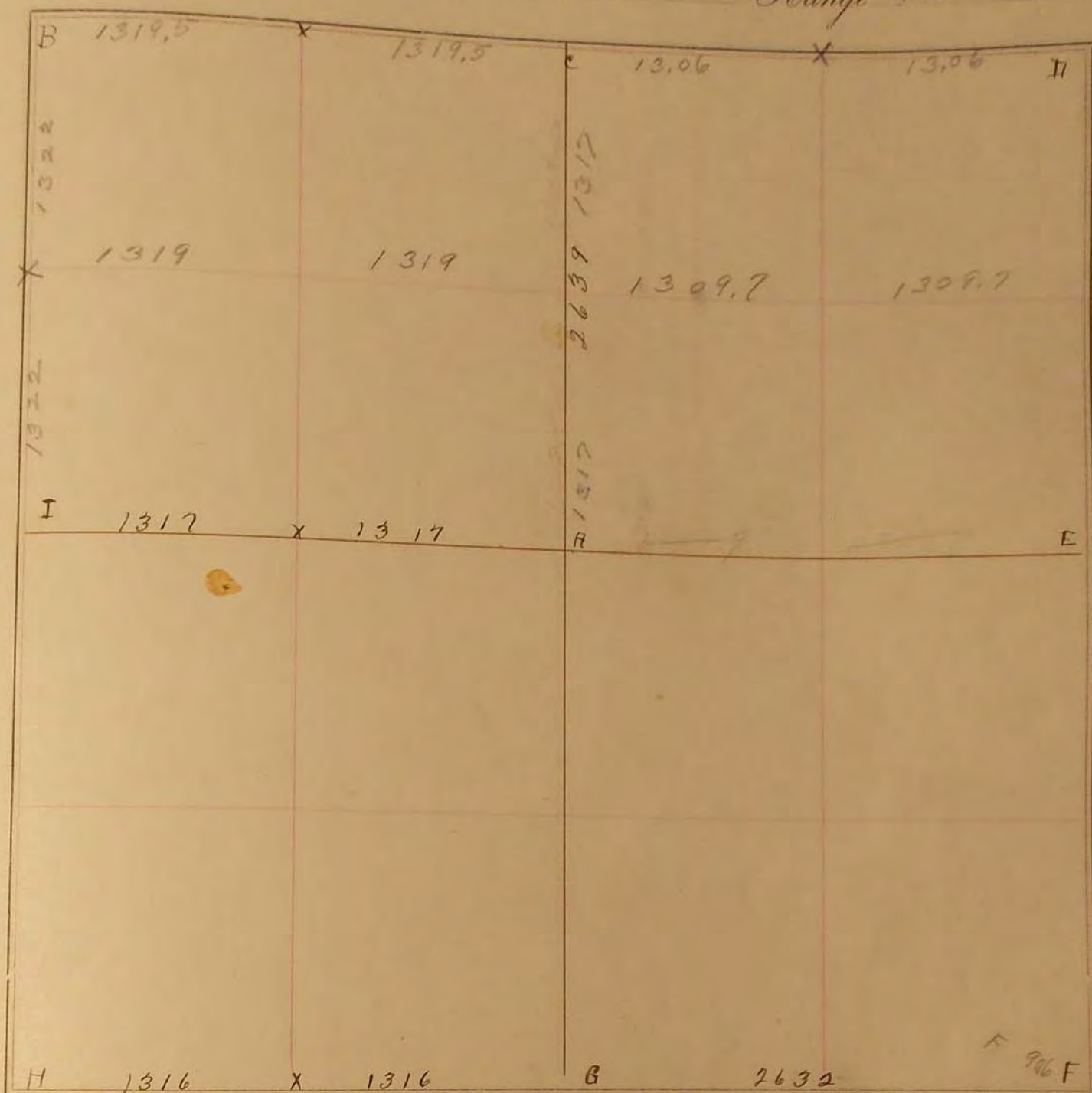

FIELD NOTES.

May, 10, 1905.

A Stone 6x6x36

B " at Gov. cor.

C " " "

D " " "

E " " "

F Established by previous survey Fence cor. 33' W + 34.5' S.

G " " "

H Stone in Gov. cor.

I " " "

X Stones on 80 lines.

J. W. Woodstencroft

Oct. 24, 1920

B Paired old stakes, put in stone 16" long and deposited small stones around